

## USB + Power Station - Surface Mount



### INSTALLATION INSTRUCTION

#### Product:

SSVCS3SS

VCS / TCS  
-282-2U  
-2821-2U  
-282-BWQAC  
-382-QAC  
-382-BWQAC  
-382-3A1C  
-BW3A1C

#### Specification:

220-240V~50Hz  
Max. 13A

#### Pack Contents:

POWER STATION x 1  
Fixing pack x 1  
Instruction leaflet x 1



#### PLEASE READ THESE BEFORE COMMENCING INSTALLATION AND RETAIN FOR FUTURE REFERENCE.

- If the external flexible cable or cord of this socket is damaged, it shall be exclusively replaced by the manufacturer or his service agent or similar qualified person in order to avoid a hazard.
- This is a Class I product. Must earth.
- If in doubt regarding these installations, consult a qualified electrician.
- CAUTION: Risk of Electric Shock - For indoor use only

### USB CHARGER SPECIFICATION

#### Dual USB Charger - USB-A / A (2U)

- Dual USB Charge Output: Max. DC 5V, 2.4A, 12W Share

#### Dual USB Quick Charger - USB-A / C (QAC)

- USB Type-A Support : QC 3.0 Quick charge
- USB Type-C Support : QC 3.0 and PD Quick Charge
- Single Quick charge Output :  
DC 5-12V, Max. DC 12V, 1.5A, 18W  
(According to different device, the smart circuit will auto detect and switch to 5 - 12V for quick charging performance)
- Dual USB charge Output: Max. DC 5V, 4A, 20W Share

\*Use correct USB cable for best charging experience

#### Quad USB Charger - USB-A x 3 / C x 1 (3A1C)

- Quad USB Charge Output: Max. DC 5V, 5.1A, 25.5W Share
- CAUTION : It is not applicable for the digital products with internal protection or the ones requiring driving programme

### OPERATION

- ON/OFF Switch only control the power supply of 13A socket

### MINIATURE AUDIO SPEAKER SPECIFICATION

- TWS (True Wireless Stereo) technology
- Input : 100-240V~50/60Hz
- Output Power : Max. 3W
- Sensitivity : L/R 380MV
- SNR : >80db
- Speaker Frequency Range : 280Hz-16KHz
- Bluetooth 5.0 chips
- Frequency Range : 2400-2483.5MHz
- Max Output Power : 5dBm
- How to Connect to Bluetooth

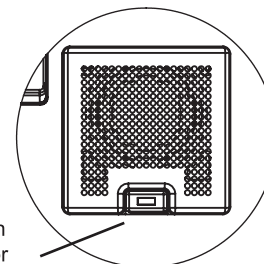

Switch On Button  
& Signal Indicator

- Switch on the power, you will see the bluetooth signal indicator start flashing.
- Open your mobile device and turn on the bluetooth function, connect the device named "TWS-SP01"
- Then press connect to the device, if the connection ok, then you will hear a "bip" sound and the bluetooth signal indicator flashing a different frequency.
- Once connected, you can start play the music now.

#### TWS - PAIRING DEVICES

1. Turn on the power of two Bluetooth speakers :  
Press and hold power button of any one speaker until power on prompt is heard and the indicator will flash;
2. In one of the device power button quickly press twice, and then wait for them to pair;
3. When the pairing is successful, you will hear the prompt. And the indicator of one device will stop flashing, it will become the sub channel, another one device will keep the flashing, it will become the main channel);
4. open the mobile phone Bluetooth function, search for "TWS-SP01", pair with it.

### MAINTENANCE

- Ensure that to disconnect the power prior to cleaning.
- To keep the finish of this product, wipe over with soft cloth periodically.
- Clean the socket with a damp cloth and mild detergent, dry immediately.
- Do not use harsh chemical solvents, it may dis-color or damage the finish.

## INSTALLATION

The installation may only be carried out by an electrical specialist in accordance with international and national standards.

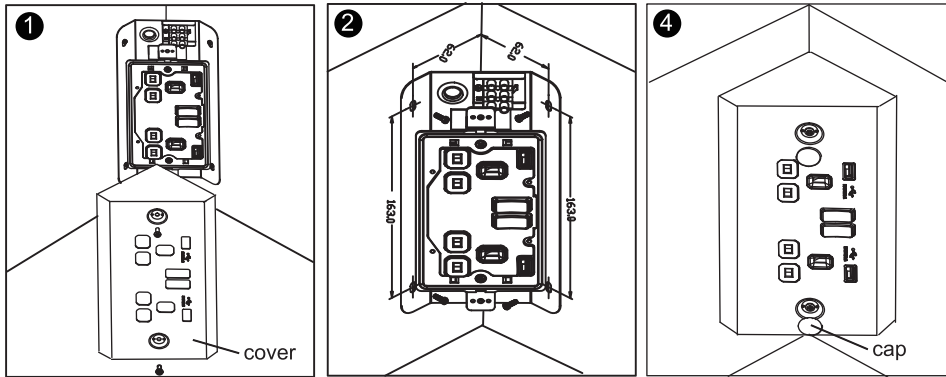

- ❶ Unscrew the the screws and remove the cover .(Picture 1)
- ❷ - If the product is fixed on the wall ,please insert wall plugs and give a tap with a mallet or hammer if necessary , then tighten the screw . (Picture 2)  
 - If the product is fixed on the wood ,please direct to tighten the screw . (Picture 2)
- ❸ Connect the supply wires to the terminal block, opposite the corresponding wires from the fitting. See '3'. Ensure that connections are tight and no loose stands of wire are left out the connector blocks. This product must be earthed - if no earth feed wire is available, consult an electrician .
- ❹ Close the cover and tighten the screws , then cover the protective cap of screws .

❸

### Terminal Block Wiring Arrangement

\*Refer to Electrical change sheet for old and new wiring cable colours

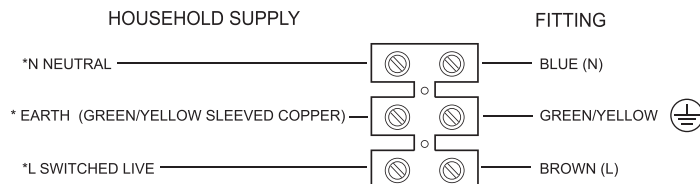

Connect the power according to above wiring diagram then power on. The product is ready to use.